

Recess-mounted fan coil with formwork

CFV 1 - 4 kW

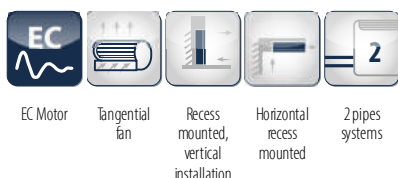
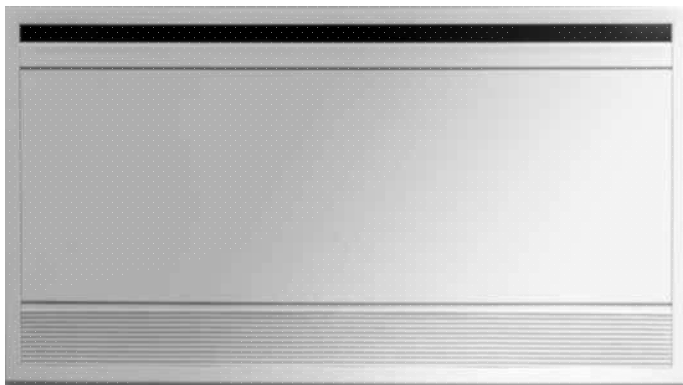

INVISIBLE AIR CONDITIONING FOR EXTRAORDINARY COMFORT

CFV is the perfect solution to meet the design requirement of completely concealing the indoor unit. The heart of this product is the CF fan coil, which is suitable for any type of installation with a depth of only 12.6 cm. Its compact dimensions are combined with low energy consumption thanks to the EC inverter motor which, in comparison to a conventional AC motor, guarantees energy savings of up to 70 % during its seasonal operation. The fan coil is housed in the galvanised steel CYC casing for both vertical and horizontal installation. Pre-cuts are provided in the metal structure at the hydraulic and electrical connections of the unit for ease of installation. The CYP front cover panel conceals the fan coil but at the same time provides easy access for all maintenance operations. Integration with the wall is maximised by the possibility of painting the front panel, which makes it literally disappear into the room to be air-conditioned.

PLUS

- » Inverter-controlled EC motor
- » Low energy consumption
- » Modulating operation
- » Easy accessibility to the fan coil
- » Paintable front panel



VERSIONS

CFV VERTICAL INSTALLATION

1. CYPV frontal panel
2. CF Fan coil
3. Formwork CYC

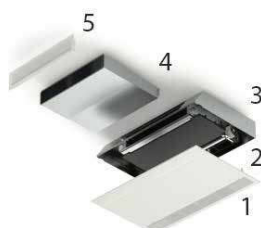

CFV HORIZONTAL INSTALLATION

1. CYPH frontal panel
2. CF Fan coil
3. Formwork CYC
4. CYRMCD telescopic duct
5. Air outlet grille with straight profile CY8048

SETTINGS

CONFIGURATOR

The models are completely configurable by selecting the version and the options. To the right is shown an example of configuration.

Version	Field	1	2	3	4	5	6	7	8	9	10	11
CF10		C	I	L	0	1	7	0	0	0	0	A

To verify the compatibility of the options, use the selection software or the price list.

CONFIGURATOR

- | | |
|--|---|
| <p>1 Version
C Recessed</p> <p>2 Motor
I Inverter motor</p> <p>3 Main coil hydraulic side
L Left
R Right</p> <p>4 Additional coil hydraulic side / heating element
0 Absent
L Left DF
R Right DF</p> <p>5 Valve
1 3-way - on/off 230V</p> | <p>2 2-way - on/off 230V</p> <p>6 Control panel
7 Circuit board on the unit for connection to MY COMFORT LARGE</p> <p>7 Probes
0 Absent</p> <p>8 Accessories
0 Absent</p> <p>9 Filter
0 Standard air filter</p> <p>10 Release
0 0
A A</p> |
|--|---|

ACCESSORIES

Electronic microprocessor control panels with display		RM C90	90° curve air supply duct
CYBOARD	On-board electronic circuit board for MYCOMFORT connection	RM CD	Telescopic air supply duct
DIST	MY COMFORT controller spacer for wall mounting	Accessories	
MCLE	Microprocessor control with display MY COMFORT LARGE	C*0A00	Galvanised sheet steel casing for 2-pipe version
MCSWE	Water sensor for MYCOMFORT and EVO controllers	C*0A01	Galvanised sheet steel casing for 4-pipe version
Air inlet and outlet grilles		P*0AH0	Ceiling-mounted cover panel with frame and intake grille for 2-pipe version
8048	Aluminium air outlet grille with 2-row fins	P*0AH1	Ceiling-mounted cover panel with frame and intake grille for 4-pipe version
Valves		P*0AV0	Wall-mounted cover panel with frame, intake grille, and outlet louver for 2-pipe version
K4S	3-way kit valve for 4 pipes system	P*0AV1	Wall-mounted cover panel with frame, intake grille, and outlet louver for 4-pipe version
KV24K	2-way kit valve for 4 pipes system	T	Motor connection cable for moving hydraulic connections from left to right on site
KVK	2-way valve with thermo-electric actuator		
Plenum, air intake modules, air inlet and outlet connectors and cabinets			

2 PIPES - RATED TECHNICAL DATA

CFV	10			20			30			40			50				
	min	med	max	min	med	max	min	med	max	min	med	max	min	med	max		
Speed																	
Control voltage	(E)	V	3,30	6,80	10,0	3,30	6,80	10,0	3,30	6,80	10,0	3,30	6,80	10,0	3,30	6,80	10,0
Total cooling capacity	(1)(E)	kW	0,43	0,73	0,91	0,75	1,36	2,12	1,15	2,08	2,81	1,32	2,39	3,30	1,36	2,57	3,71
Sensible cooling capacity	(1)(E)	kW	0,29	0,51	0,71	0,59	1,04	1,54	0,83	1,51	2,11	1,02	1,84	2,65	1,05	1,98	2,90
FCEER class	(E)		C			B			A			A			A		
Water flow	(2)	l/h	74	126	157	129	234	365	198	358	484	227	412	568	234	443	639
Water pressure drop	(2)(E)	kPa	6	10	12	2	4	8	3	10	17	3	9	18	3	11	21
Heating capacity	(3)(E)	kW	0,37	0,69	1,02	0,82	1,53	2,21	1,20	2,16	3,02	1,47	2,59	3,81	1,49	2,82	4,32
FCCOP class	(E)		D			B			B			B			B		
Water flow	(3)	l/h	64	119	176	141	263	381	207	372	520	253	446	656	257	486	744
Water pressure drop	(3)(E)	kPa	3	7	9	2	4	9	3	9	19	3	9	21	3	7	23
Rated air flow		m ³ /h	49	90	146	118	210	294	180	318	438	247	410	567	262	479	663
Power input	(E)	W	5	7	11	4	8	19	6	11	20	5	11	29	6	12	33
Total sound power level	(4)(E)	dB(A)	37	47	54	37	47	54	37	47	54	37	47	55	37	48	57

(1) Water temperature 7°C/12°C, air temperature dry bulb 27°C, wet bulb 19°C (47% relative humidity) according to EN1397:2021

(2) Water temperature 7°C / 12°C, air temperature dry bulb 27°C, wet bulb 19°C (47% relative humidity)

(3) Water temperature 45°C / 40°C, air temperature 20°C

(4) Sound power measured according to standards ISO 3741 and ISO 3742

(E) EUROVENT certified data

Power supply 230-1-50 (V-ph-Hz)

Hydronic indoor units CFV

DIMENSIONAL DRAWINGS

CYC

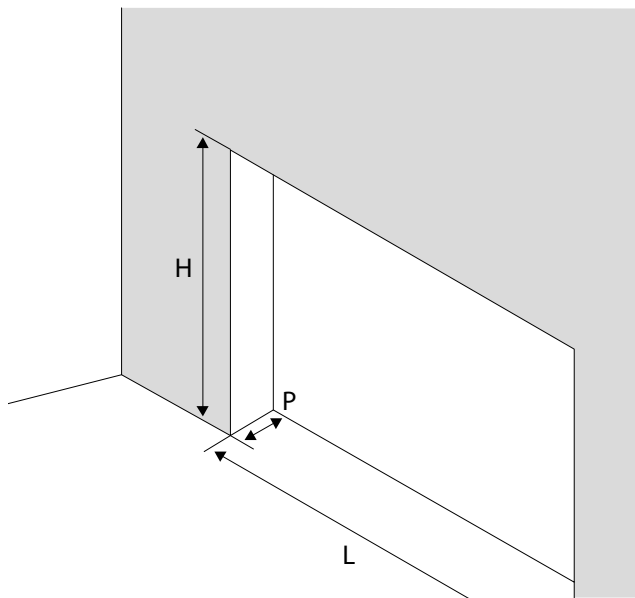

CYP

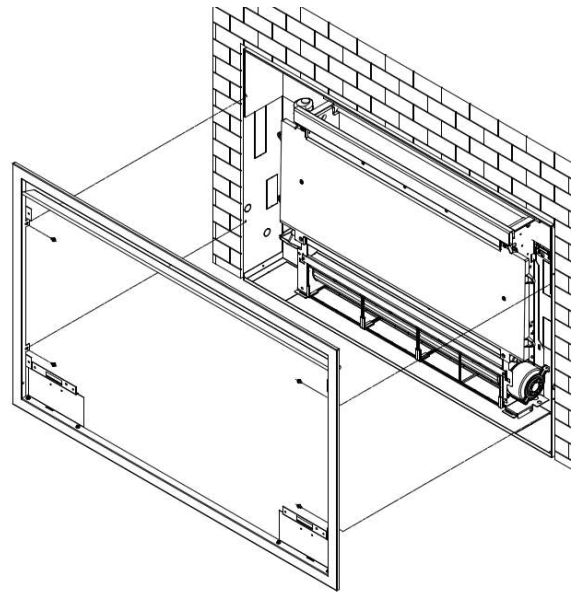

Mod.	L mm	H mm	P mm
CF10CI	740	730	142
CF20CI	940	730	142
CF30CI	1140	730	142
CF40CI	1340	730	142
CF50CI	1540	730	142

CF 2 pipes

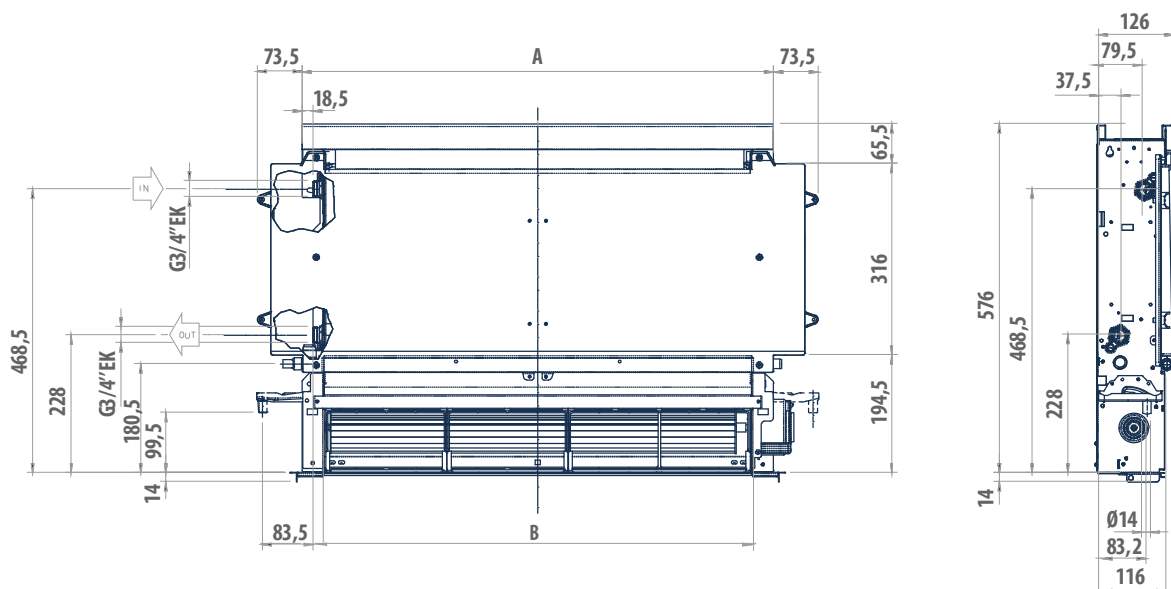

Mod.	A mm	B mm
CF10CI	378	305
CF20CI	578	505
CF30CI	778	705
CF40CI	978	905
CF50CI	1178	1105